

MULLIFARRY DR. & PIKE RD. CLOSED BETWEEN NAPPERTON DR. & CENTRE RD.

MULLIFARRY DR. & PIKE RD. CLOSED BETWEEN NAPPERTON DR. & CENTRE RD.

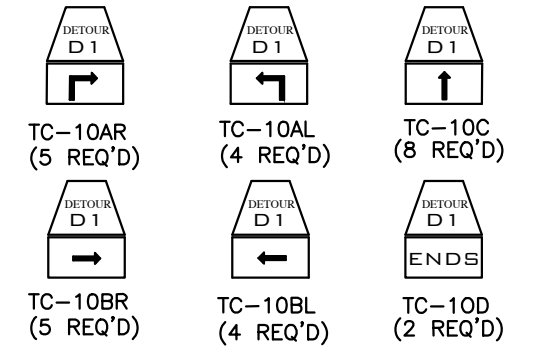
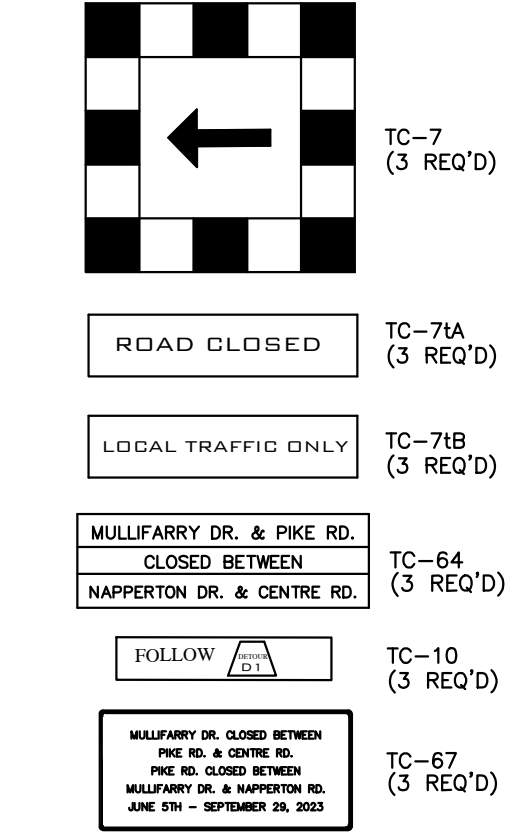

LOCATION OF FULL CLOSURE IS BTWN. NAPPERTON DR. & CENTRE RD.

DATE	REVISIONS	BY
DETOUR OF CR 33 & CR 45		
COUNTY OF MIDDLESEX		
MULLIFARRY DR. AND PIKE RD. CLOSED FOR RECONSTRUCTION		
MUNICIPALITY OF THAMES CENTRE		
DRAWN D.M.	CHECKED R.H.	DESIGNED D.M.
		SCALE N.T.S.
JOB No. 70170 & 70149		COUNTY ROAD No. 33 & 45
33_3160_45_27975_DET_23 FILE No.		CHRIS TRAINI COUNTY ENGINEER 2023/04/17