

NORTH MIDDLESEX

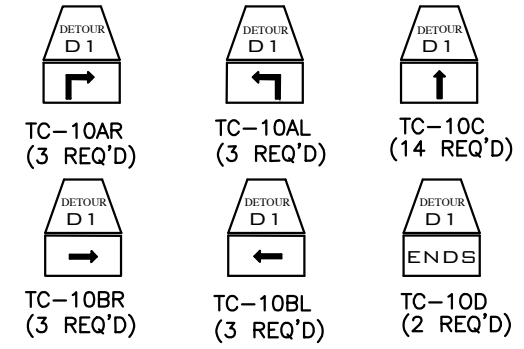
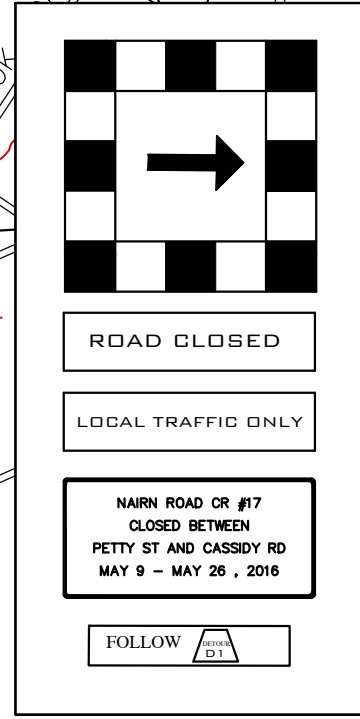
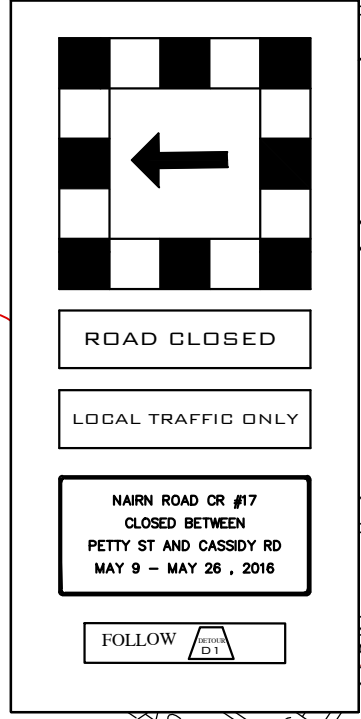
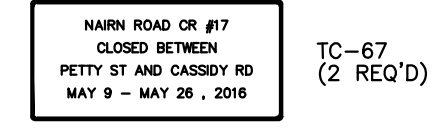
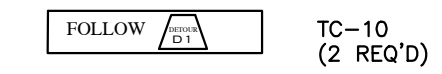
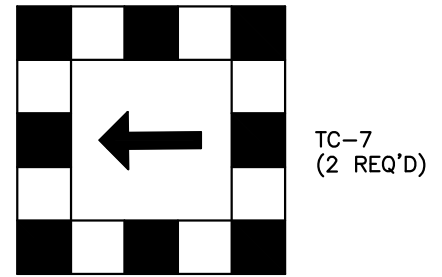
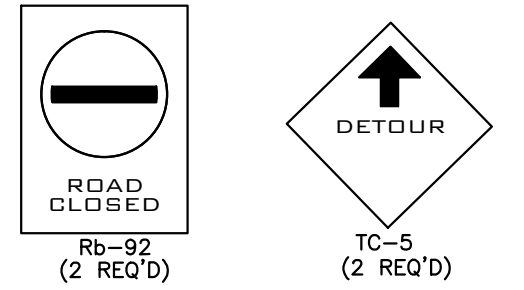
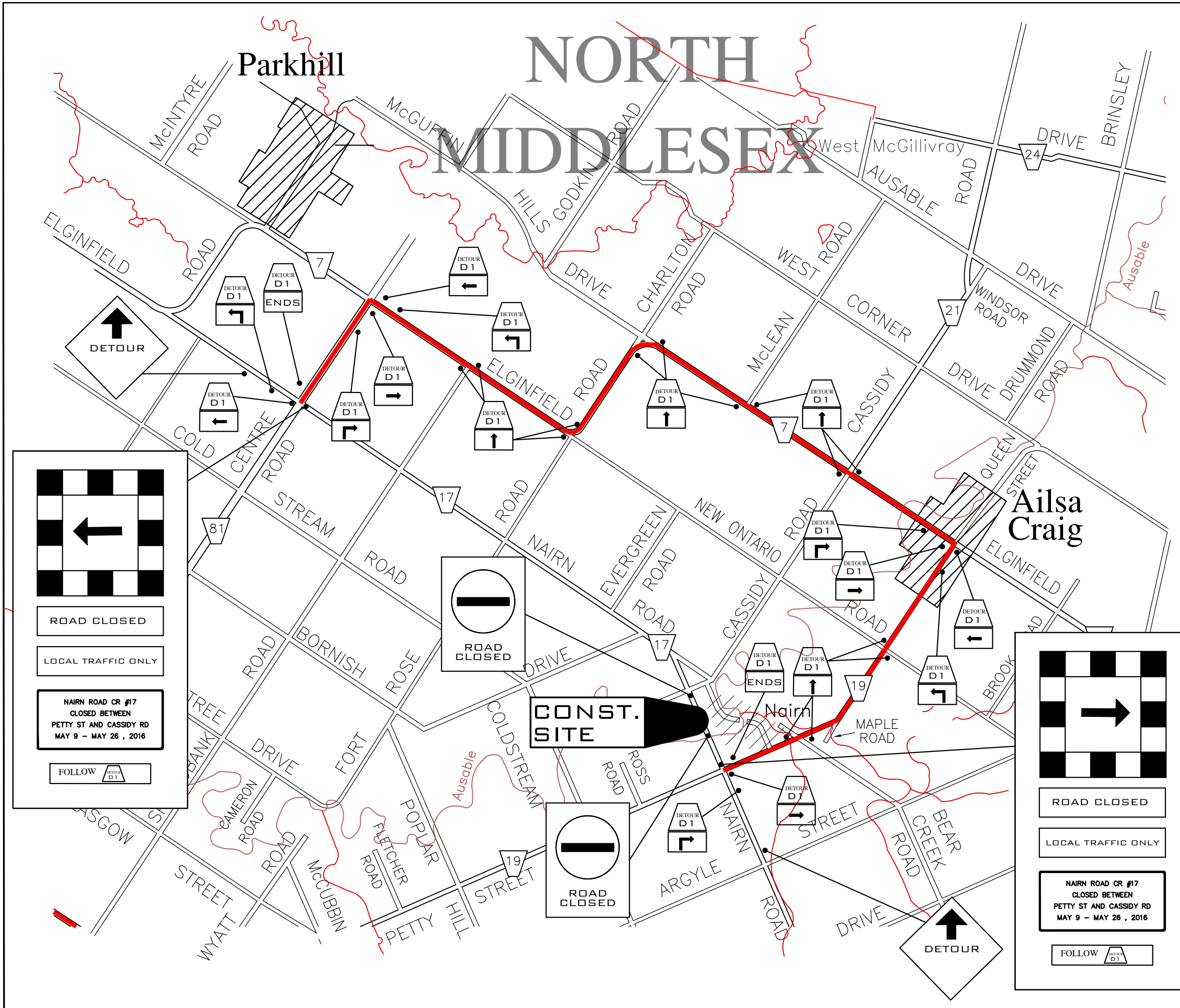

LOCATION OF FULL CLOSURE IS BTWN. PETTY ST AND CASSIDY RD

DATE	REVISIONS	BY
DETOUR OF CR 17 (NAIRN ROAD)		
COUNTY OF MIDDLESEX		
NAIRN ROAD CLOSING FOR BRIDGE 19-443 REPAIR		
MUNICIPALITY OF NORTH MIDDLESEX		
DRAWN R.H.	CHECKED J.R.	DESIGNED R.H.
SCALE N.T.S.		
JOB No. 77026	COUNTY ROAD No. 17	
17_NAIRN_DET_16 FILE No.	CHRIS TRAINI COUNTY ENGINEER APRIL 27, 2016	